

SV200

INSTALLATION INSTRUCTIONS TILE ROOF

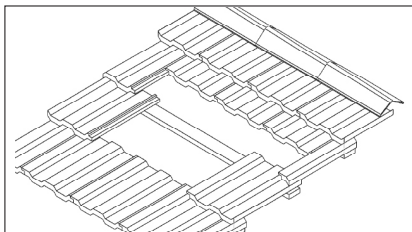

Step 1

Push back three tiles above the two tiles you have selected as install location.

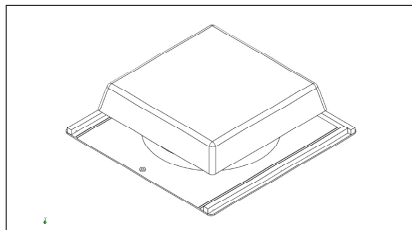

Step 2

Remove backing & place Foam Strip on the top and two sides of the Flange, ensuring to cover holes.

Note: Vent is positioned portrait - longer side running upward (see lines on flange).

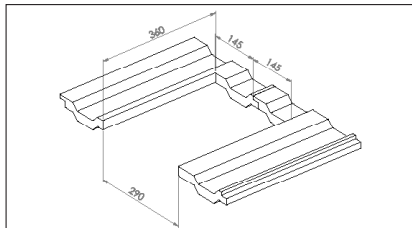

Step 3

Using an Angle Grinder, cut out an opening between the two tiles for the Vent.

From the bottom of each tile, cut up 360mm, 145mm in from the Vent edge.

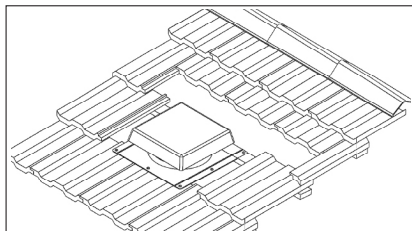

Step 4

Fix Vent to Batten using screw, so the Vent will accommodate cut tiles.

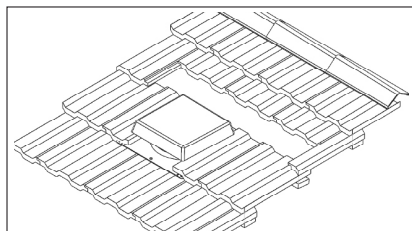

Step 5

Replace two cut tiles so surrounding Vent

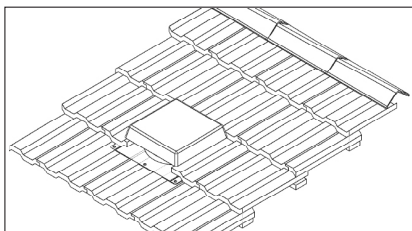

Step 6

Pull down top three tiles into original position.

SV200

INSTALLATION INSTRUCTIONS CORRUGATED ROOF

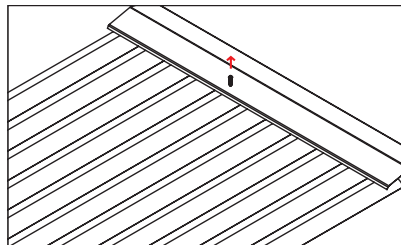

Step 1

Remove screw from Ridge Cap.

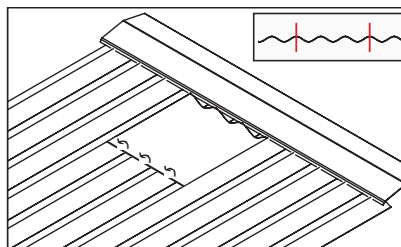

Step 2

Centre cut out between 5 Ribs. Cut 300mm x 300mm hole so edges of hole align with the highest point of ridges.

Bend back low points of Ribs back to prevent water blowing past.

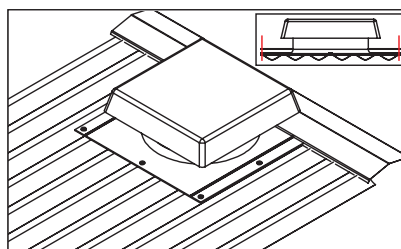

Step 3

Tuck Unit Flange under Ridge Cap so the side screw holes are aligned with highest point of ridges.

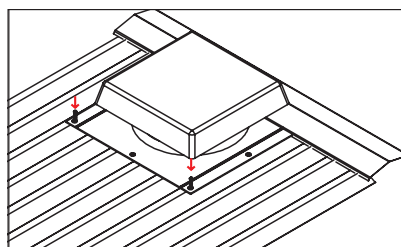

Step 4

Return Ridge Cap screw into original position by drilling through Unit Flange to fix.

Fix lower point of Unit by drilling screws through Flange holes onto highest point of ridges.

SV200

INSTALLATION INSTRUCTIONS TILE ROOF

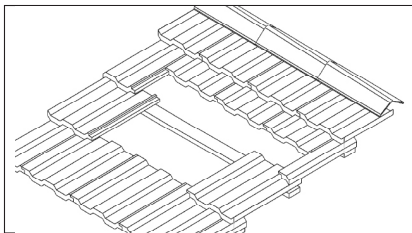

Step 1

Push back three tiles above the two tiles you have selected as install location.

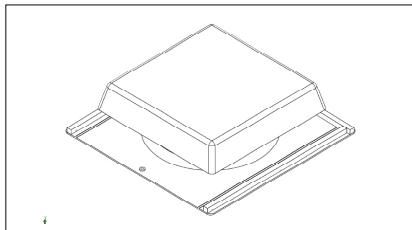

Step 2

Remove backing & place Foam Strip on the top and two sides of the Flange, ensuring to cover holes.

Note: Vent is positioned portrait - longer side running upward (see lines on flange).

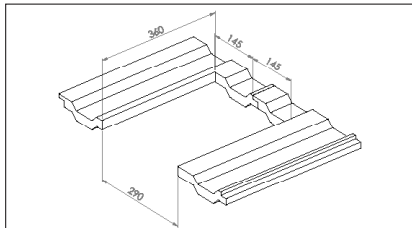

Step 3

Using an Angle Grinder, cut out an opening between the two tiles for the Vent.

From the bottom of each tile, cut up 360mm, 145mm in from the Vent edge.

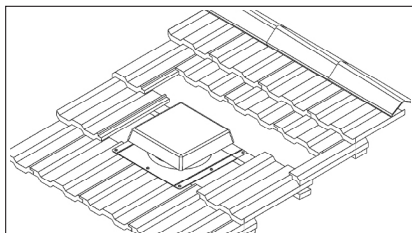

Step 4

Fix Vent to Batten using screw, so the Vent will accommodate cut tiles.

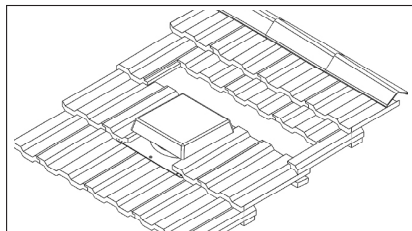

Step 5

Replace two cut tiles so surrounding Vent

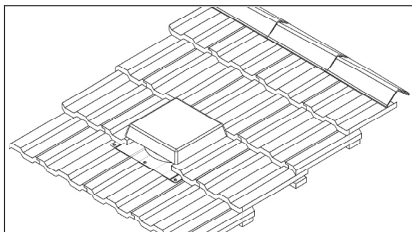

Step 6

Pull down top three tiles into original position.

SV200

INSTALLATION INSTRUCTIONS CORRUGATED ROOF

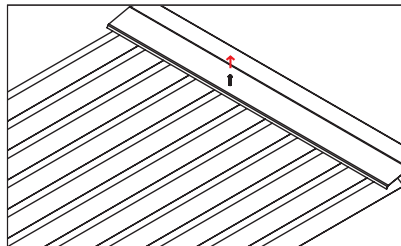

Step 1

Remove screw from Ridge Cap.

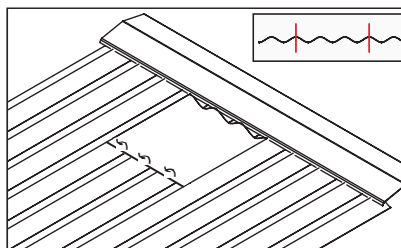

Step 2

Centre cut out between 5 Ribs. Cut 300mm x 300mm hole so edges of hole align with the highest point of ridges.

Bend back low points of Ribs back to prevent water blowing past.

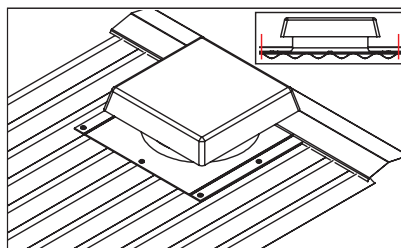

Step 3

Tuck Unit Flange under Ridge Cap so the side screw holes are aligned with highest point of ridges.

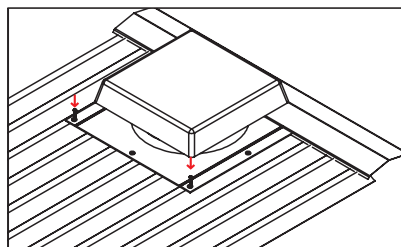

Step 4

Return Ridge Cap screw into original position by drilling through Unit Flange to fix.

Fix lower point of Unit by drilling screws through Flange holes onto highest point of ridges.